

# SCHMIDT L100 SERIES COUPLINGS

L115A Model

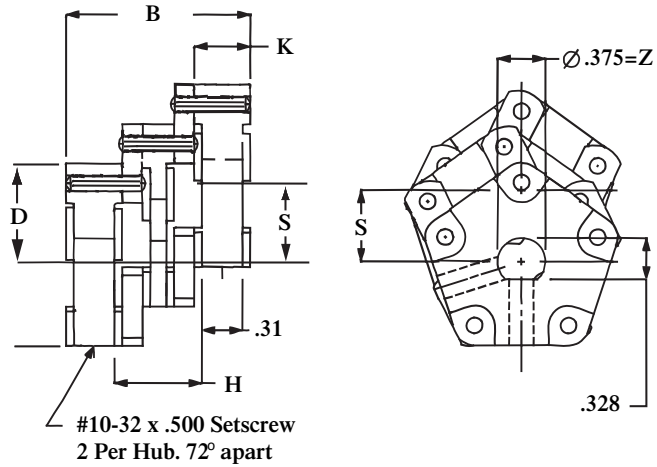

L119A Model

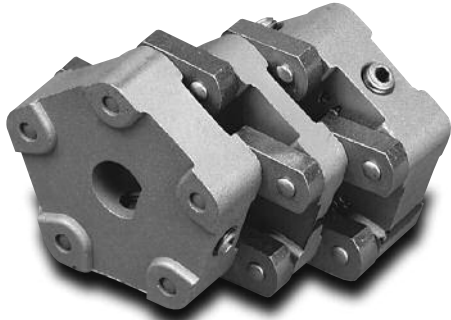
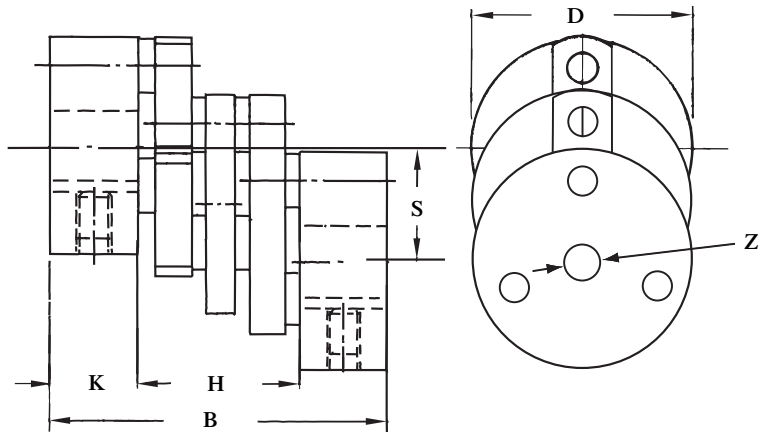

Coupling Designation		Part No.	
		L115A	L119A
Disc Diameter	D	1.562	1.900
Coupling Length ±0.040	B	1.438	2.927
Shaft Bore Diameter (Bore Tolerance +0.002-0.000)	Z	0.375 (d-shaped bore)	0.500
			0.625
			0.750
			0.875
Disc Width	K	0.438	0.750
Shaft Separation	H	0.682	1.427
Shaft Displacement	S	0.625	1.000
Minimum Operational Shaft Displacement	S <sub>min</sub>	0.156	0.250
Maximum Operational Shaft Displacement	S <sub>max</sub>	0.562	0.900
Maximum Linear Operational Shaft Displacement	S <sub>ml</sub>	1.080	1.728
Coupling Weight (Lb)		0.400	1.400
Inertia Wk <sup>2</sup> (Lb-In <sup>2</sup> )		0.100	0.555

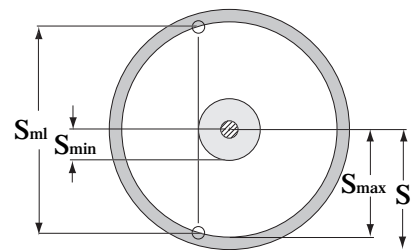

Recommended operational area for shaft displacement

Performance Data				
Coupling Designation	Maximum Torque Capacity* (In-Lb)	Horsepower Capacity	Practicle Speed Limit (rpm)	Lowest Speed Limit for Maximum Torque (rpm)
L115A	140	0.37	4,000	160
L119A	400	0.50	3,000	80

Notes: \*The maximum torque capacity of the coupling is based on a 5,000 psi bearing unit load



DISTRIBUIDOR AUTORIZADO

MEX (55) 53 63 23 31  
QRO (442) 1 95 72 60

MTY (81) 83 54 10 18

ventas@industrialmagza.com